

# Swing Check Valve

Swing check valves allow flow in one direction, but not both. Swing check valves are also referred to as clack, non-return, stop, check and one-way valves. Swing check valves allow almost un-obstructed flow through the valve with a correspondingly low pressure drop.

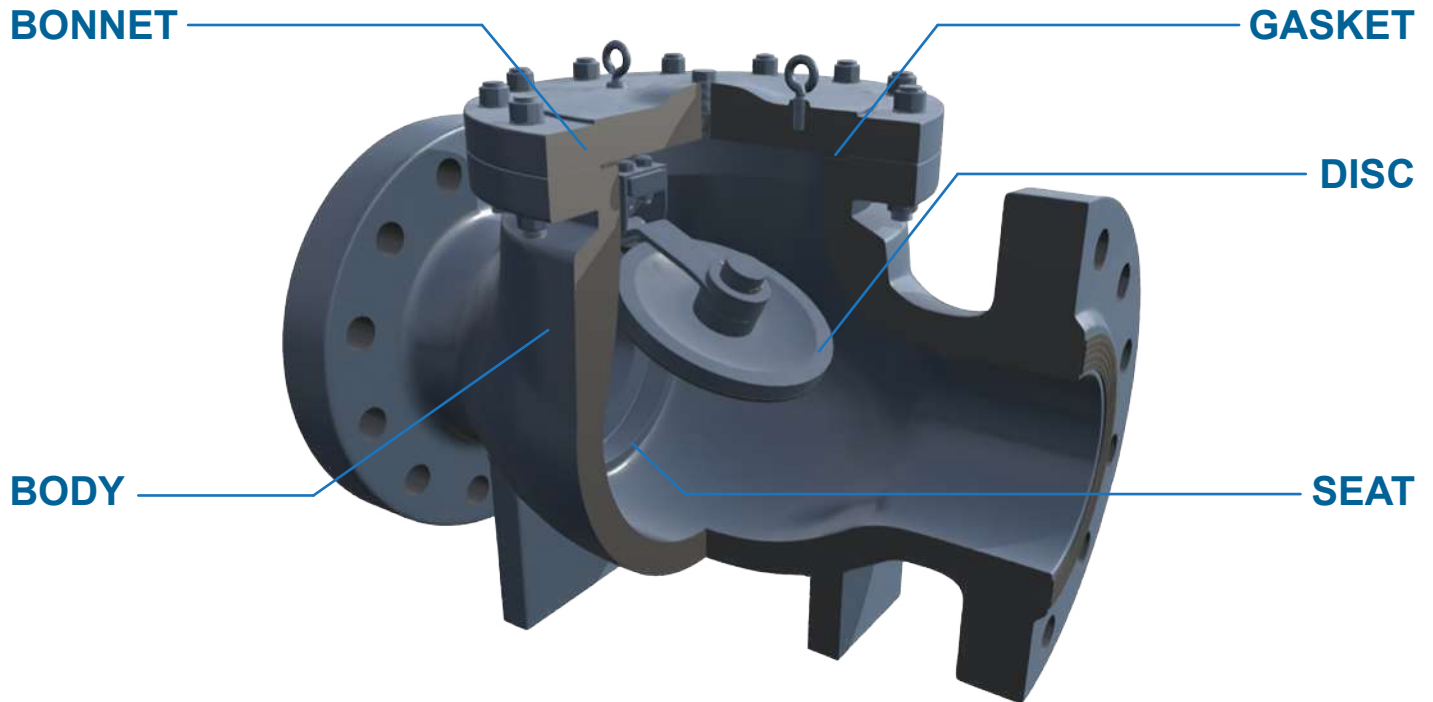

## **ADVANTAGES**

Swing check valves allow almost un-obstructed flow through the valve with a correspondingly low pressure drop.

Accessing the valve's internals (trim) is easy due to the large bonnet.

Swing check valves are ideal for low-medium velocity flow applications.

## **DISADVANTAGES**

Swing check valves are not well suited for applications where pressure fluctuations often occur.

Rapid or constantly varying pressure fluctuations will lead to the valve opening and closing frequently (chattering); this will lead to wear of the disc and seat.